



INSTALLATION INSTRUCTIONS

Vehicle Application

Year: **2007-10**
 Make: **Chevrolet / GMC**
 Model: **Silverado / Sierra**
2500HD, 3500
 Engine: **6.6L Duramax "LMM"**

Tools Required

- 10mm Wrench or Socket
- 1/2" Wrench or Socket
- T-20 Security Torx Wrench (Supplied w/ Kit)
- 5/16" Nut Driver or Flat Blade Screwdriver
- Phillips Screwdriver

S&B Filter Maintenance

Cleanable (KF-1035). If the enclosed filter is Red, it came pre-oiled from the factory. Please visit www.sbfilters.com for the exact oil amount required after cleaning.

Disposable (KF-1035D). If the enclosed filter is White, it is a disposable filter and should be discarded once it reaches capacity. This filter **(does not require oil)**. For more info on S&B's disposable filter, visit www.sbfilters.com.

Notes

Kit may not fit with the following:

- Aftermarket Parts installed
- Body Lift or Lowering Kit
- Custom Hood
- Intercooler or Turbo upgrades

Before You Start

- Please read the entire product guide before proceeding.
- Ensure all components listed on page 4 are present.
- If you are missing any of the components, call our customer support at (909) 947-0015.
- Do not attempt to work on your vehicle while engine is hot.
- Make sure the engine is turned off and the vehicle is in Park or the Parking Brake is set.

1. With the ignition switched off and the parking brake set, disconnect the negative battery cables on both batteries.



2. Disconnect the electrical connection at the MAF sensor on the OE air box tube.



3. Loosen both hose clamps and remove the OE intake tube from the vehicle.



4. Pull up on the OE air box to remove it from the vehicle, there are two press prongs that go into rubber grommets on the bottom side.

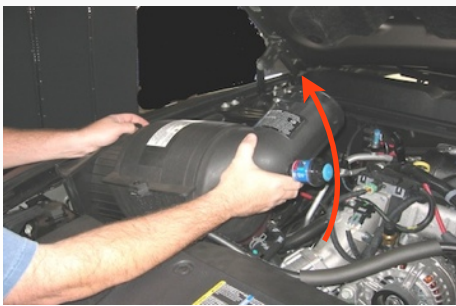

5. Make sure that the OE grommets are still in place in the OE air box tray. They may have pulled out with the air box removal.

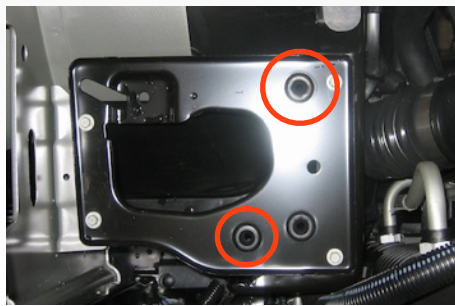

6. Remove the headlight housing bolt in the radiator core support between the passenger side fender and the hood bumper.



7. Place the Air Filter (C) inside the Air Box (A), then attach the Filter Adapter (B) clip into the bottom of the Air Box. Secure using the 5/16" bolts (G) & washers (T). Secure the #80 hose clamp (D) at the Filter.

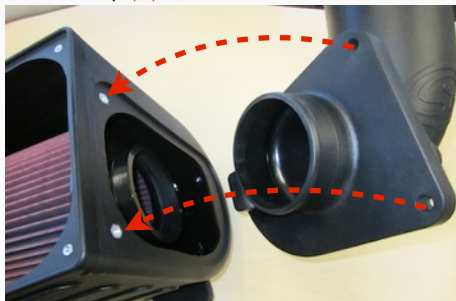

8. Remove the OE Filter Minder and OE Grommet. Insert the grommet into the Filter Adapter Tube (B). Then push the Filter Minder into the grommet.

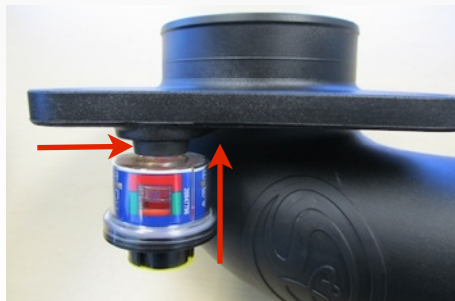

9. Remove the MAF sensor from the OE air box using the supplied T-20 Torx wrench. Make sure the rubber seal stays with the MAF sensor.



SEE EXPLODED VIEW ON PAGE 3



INSTALLATION INSTRUCTIONS (continued)

10. With the rubber seal in place, insert the MAF sensor into the Filter Adapter (B). Secure the MAF sensor using the supplied M4 screws (P). **Do not over tighten!**

The screws may require a Phillips head screwdriver and not a Torx.



11. Test fit the Air box assembly. If there is a clearance issue with the Air Box (A) it may be necessary to loosen the bolt at the base of the coolant overflow/ reservoir then slide the reservoir back and retighten the bolt.



12. Place the Air box assembly in the vehicle aligning the prongs into the OE grommets.



13. Secure the front of the box using the supplied 6mm Allen Head Bolt (S) and the thin SS Washer (R).



14. Install the Hump Coupler (M) along with the #80 Hose Clamps (D) over the Intake Tube (L). Slide on until it is just about flush with the end of the tube.



15. With a #64 Hose Clamp (E) and a #72 Hose Clamp (F) installed on the Straight Coupler (N), secure the smaller end to the Intake tube (L).



16. Connect the Intake tube assembly to the turbo inlet and secure the #72 Hose Clamp (F). Center the Hump Coupler (M) over the gap between the tube ends and secure both #80 Hose Clamps (D).



17. Reconnect the MAF sensor electrical connection.



18. Install the Clear Lid (H) and secure with the 10/24 screws (K) and SS Sealing Washers (J). **Do not over tighten!**



19. Reconnect both batteries. Inspect your installation, make sure the kit is properly positioned and all fasteners are secure. Affix the CARB sticker near the intake kit. The installation is now complete.



Related Items for your Purchase

- Precision II Cleaning and Re-oiling Kit (S&B P/N: 88-0008)
- Replacement Air Filter (Oiled) (S&B P/N: KF-1035)
- Replacement Air Filter (Dry) (S&B P/N: KF-1035D)
- Air Filter Wrap (S&B P/N: WF-1023)

Performance Testing

- Engage parking brake and start your engine. Listen for abnormal noises. If an air leak is detected, re-inspect hoses and connections as they may need to be repositioned and tightened.
- S&B FILTERS recommends that you keep your OE intake system in the event it is required in the future.
- In order to maintain your warranty, all connections and components must be checked periodically for alignment and for proper tension on all connections. Failure to do so may void your warranty.
- Use only S&B FILTERS cleaning and oil products to service your filter. Using any other brand oil and or cleaners on your S&B air filter may void your warranty.

SEE EXPLODED VIEW ON PAGE 3



EXPLODED VIEW

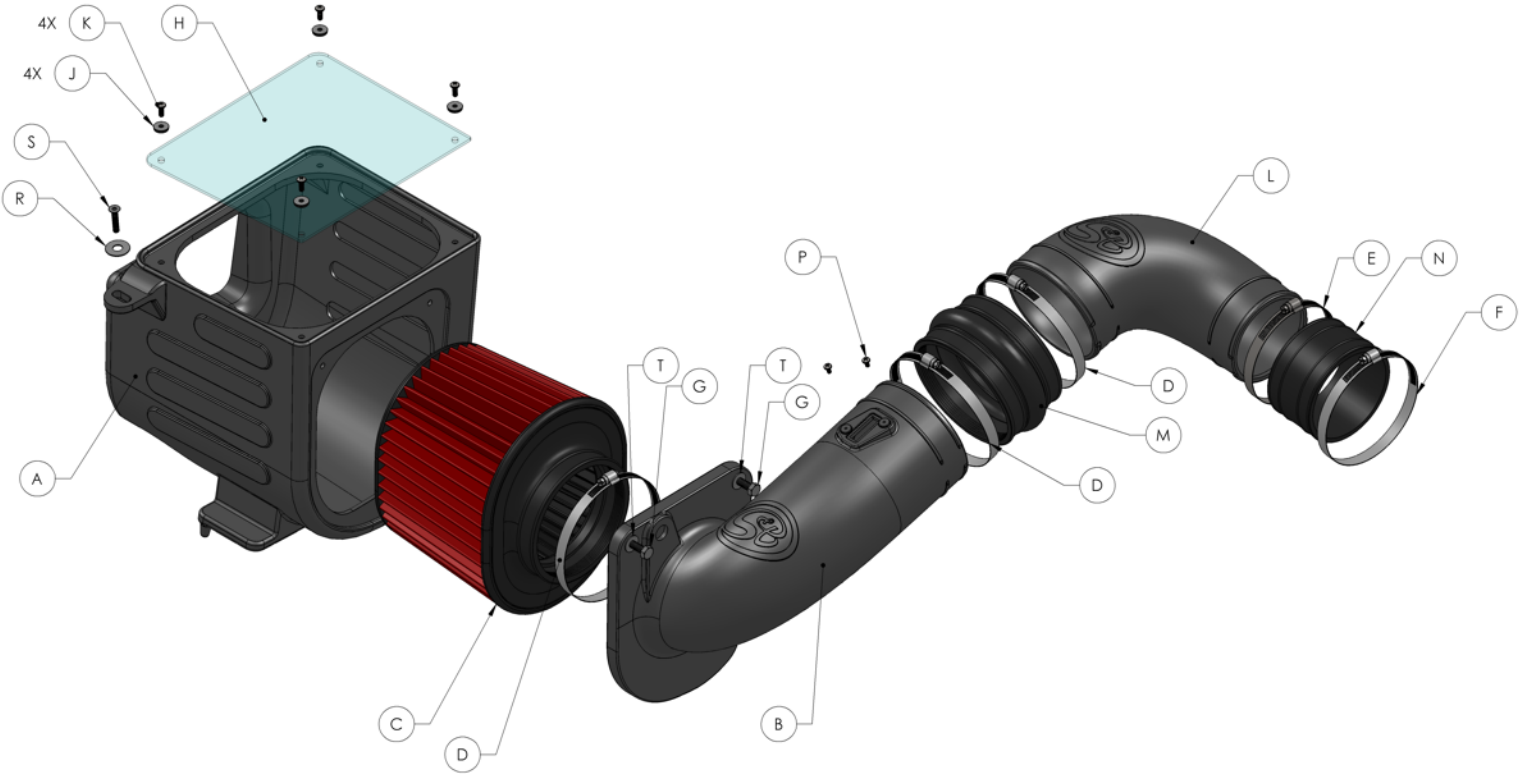

ITEM	QTY.	DESCRIPTION	P/N
A	1	Air Box	AL1178B-00
B	1	Filter Adapter Tube	AL1204-00
C	1	S&B Air Filter	KF-1035
D	3	Hose Clamp, #80	AG1010-00
E	1	Hose Clamp, #64	AG1018-00
F	1	Hose Clamp, #72	AG1009-00
G	2	Hex Cap Screw, 5/16-18x1.25"	AI1391-00
H	1	Clear Lid	AI1359-00
J	4	Sealing Washer, #10	AI1272-00
K	4	Pan Head Screw, #10-24x1/2"	AI1287-00
L	1	Intake Tube	AL1078-00
M	1	Hump Coupler, 5.0"ID x 3.0"	AI1338-00
N	1	Straight Coupler, 4.0"ID x 2.5"	AI1354-00
P	2	Pan Head Screw, M4x.7x8mm	AI1360-00

ITEM	QTY.	DESCRIPTION	P/N
R	1	Washer Flat, 3/8"ID	AI1341-00
S	1	Flat Allen Screw, M6-1.0x30mm	AI1366-00
T	2	Washer Flat, 5/16"ID	AI1073-00

AM0121-00 Rev.H 6/17/13